

- Designed to replace nylon socket type coupling, pin type coupling, suitable for hydraulic pumps, centrifugal pumps, screw type air compressors and other small and medium-sized equipment.
- Steel hub should be used when the circumferential speed exceeds 35m/s.
- Torsionally flexible, maintenance-free.
- Light mass, small moment of inertia.
- Damping impact and vibration.
- Axial plug-in, fail-safety.
- Good dynamic properties.
- Maximum torque of elastomer is twice of the rated torque.
- Mounting instructions at 03.101.

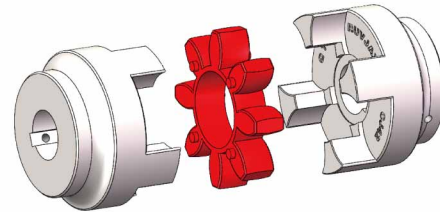
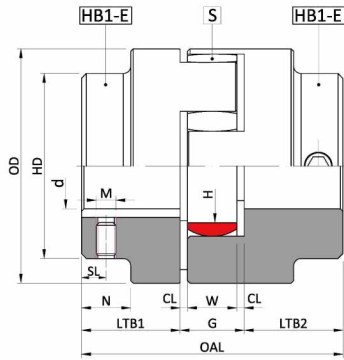

Fig 03.40

Size	Hub	Spider Rated Torque   N.m			Dimensions   mm										Set Screw		
		92ShA	98ShA	64ShD	d	OAL	LTB1:LTB2	G	W	CL	OD	H	HD	N	SL	M	T <sub>A</sub>
-	-	190	325	405	12-38	79	27	24	18	3.0	80	38	66	20	15	M8	10
38	E	265	450	560	12-42	90	32	26	20	3.0	95	46	75	22	20	M8	10
42	E	310	525	655	15-48	108	40	28	21	3.5	105	51	85	29	20	M8	10
48	E	410	685	825	20-55	119	44	30	22	4.0	120	60	98	28	20	M10	17
55	E	625	940	1175	22-65	152	58	35	26	4.5	135	68	115	40	20	M10	17
65	E	1280	1920	2400	30-75	178	69	40	30	5.0	160	80	135	47	25	M10	17
75	E	2400	3600	4500	40-90	203	79	45	34	5.5	200	100	160	55	30	M12	40

- D is the bore diameter, the metric cylindrical bores with H7 feather keyway according to DIN6885 sheet, JS91 and set screw, tolerance JS9. The inch bore is in accordance with AGMA9002-C14 standard, the bore is clearance fit, and the keyway is commercial grade.
- Hexagon socket set screws with cup point is in accordance with DIN EN ISO4029, hardness class 45H. T<sub>A</sub> is tightening torque, unit: Nm.
- Taper bore, spline bore details, please contact RUVJAX.